



£375,000

THOMAS
MERRIFIELD

SALES LETTINGS

119 Flatford Place Kidlington Oxon OX5 1TG

119 Flatford Place

Kidlington Oxon OX5 1TG

Situated at the end of a 'No-Through' road we are delighted to offer this nicely presented 3 bedroom family home being offered for sale for the first time since new. As you enter the entrance hall a door leads to a lounge/dining room, conservatory, modern fitted kitchen, utility area with downstairs cloakroom and an internal door leading to the garage. Upstairs there is an airing cupboard with gas boiler and hot water tank, 3 bedrooms and a modern fitted shower room. Outside there is a good sized pleasant rear garden and an open plan front garden and shrub border to the side along with driveway leading to the garage. The property is being sold with vacant possession and viewing is strongly recommended.

Kidlington is a large Oxfordshire village with many local amenities including a sports centre, police station, fire station, supermarkets, independent and national retailers, library, 2 doctors' surgeries, dentists, Post Office, 4 primary schools (including 1 Catholic) and 1 secondary school. There is also a choice of good restaurants offering a variety of cuisines. The village is ideally situated with easy access to the M40 and Oxford City Centre via a regular bus service. The Oxford Parkway railway station (1.5 miles) provides easy access to London. Other nearby stations are at Oxford City Centre c5 miles) and Bicester c10 miles).

Local Authority: Cherwell District Council Tax Band: D



Directions: From Oxford proceed into Kidlington onto the main Oxford Road. Continue through 4 mains sets of traffic lights onto the Banbury Road. Take the next left onto Lyne Road and turn right into Flatford Place.





- Staggered end Terrace
- Family Home
- 3 Bedrooms
- Modern Kitchen
- Modern Shower Room
- Integral Garage
- Cloakroom
- Good sized Garden
- End of 'No-Through' road
- No chain

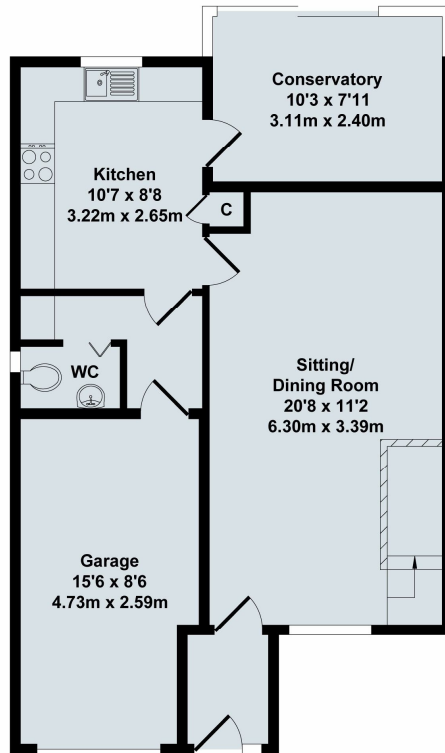

Ground Floor

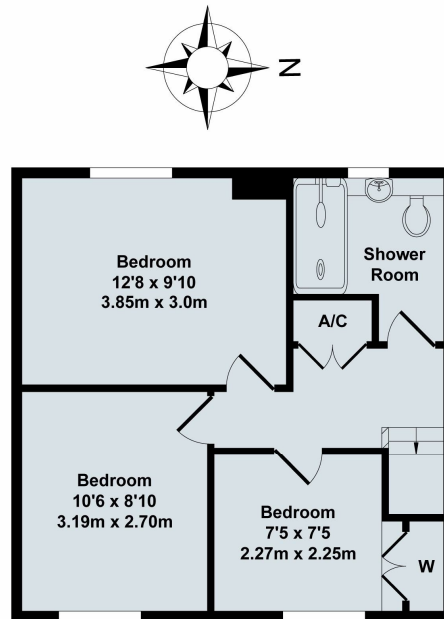

First Floor

Total Approx. Floor Area 1046 Sq.Ft. (97.20 Sq.M.)

All items illustrated on this plan are included in the "Total Approx Floor Area"

**THOMAS
MERRIFIELD**
SALES LETTINGS

Contact:

1b The Hampden Building, High Street, Kidlington, Oxon, OX5 2DH

Tel: +44 (0)1865 379880

E-mail: kidlington@thomasmerrifield.co.uk

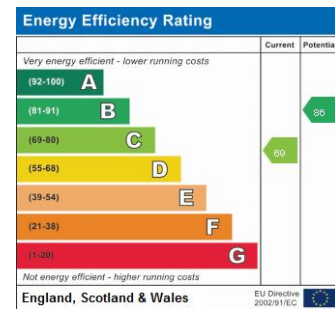

Important Notice

Thomas Merrifield for themselves and their clients give notice that:-

1. They are not authorised to make or give representation or warranty in relation to this property, either on their own behalf or on behalf of the Seller. They assume no responsibility for any statement made in these particulars. These particulars do not form part of any offer or contract and must not be relied upon as statements or representations of fact.
2. Whilst every attempt has been made to ensure the accuracy of the floorplan contained here, measurements of doors, windows, rooms and any other items are approximate and no responsibility is taken for any error, omission, or mis-statement.
3. All areas, measurements or distances are approximate. The particulars are intended for guidance only and are not necessarily comprehensive. A wide angle lens may have been used in photography. Thomas Merrifield have not tested appliances or services and it should not be assumed that the property has all necessary planning, building regulation and other consents. Buyers must satisfy themselves with the property by inspection or otherwise.
4. Reference to any mechanical or electrical equipment does not constitute a representation that such equipment is capable of fulfilling its function and prospective Buyers must make their own enquiries.
5. They have no responsibility for any expenses or costs incurred by prospective Buyers in inspecting properties which have been sold, let or withdrawn. Applicants are advised to contact the Agent to check availability and any other information of particular importance to them, prior to inspecting the property, particularly if travelling some distance.